

POLICE

www.policelifestyle.com



PE903
INSTRUCTION MANUAL

ADJUSTING THE STOPWATCH HAND POSITION

If either of the stopwatch hands are not in the "0" position, reset them following the procedure below

- ◆ Pull the crown out of second click
- ◆ Press button A to reset 1/10 second hands to "0" position; Press button B to reset Chrono minute hands to "0" position.

*The stopwatch minute hand moves correspondingly with the stopwatch second hands.

*Each time you press the corresponding button, the pointer jumping one step, The hands move quickly if the buttons are kept pressed

- ◆ Push the crown back to the normal position

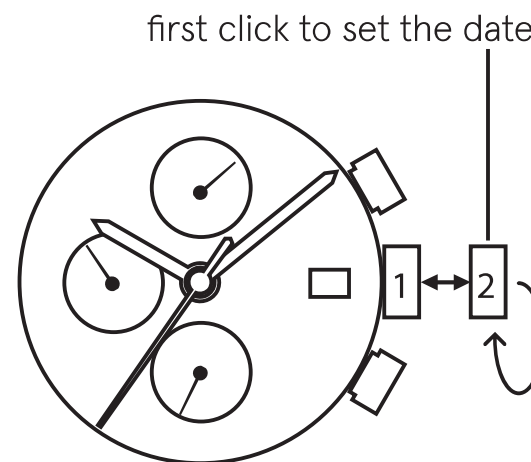

TIME SETTING

*Before setting the time, check that the chronograph measurement is stopped.

- ◆ Pull out the crown to the first click
- ◆ Turn the crown clockwise until the preview day's date appears.
- ◆ Pull out the crown to the second click when the second hand is at the 12 o'clock position. It will stop on the spot. Set the hands to the desired time of the day (make sure AM/PM is set correctly) by turning the crown.

* When the crown is at the second click position, do not press any button. Otherwise the chronograph hands will move.

- ◆ Push the crown back in the normal position in accordance with a time signal.

*Do not set the date between 9:00 P.M. and 1:00 A.M., otherwise the day may not change properly. If it is necessary to set the date during the time period, firstly change the time to any time outside of it, set the date and then reset to the correct time.

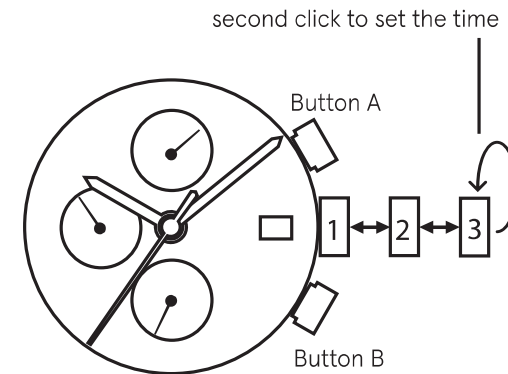

HOW TO USE THE STOPWATCH

- ◆ The measurement time is indicated by the stopwatch hands that move independently of the center hands (and 24-hour hand where applicable).
- ◆ The stopwatch can measure up to 60 minutes
- ◆ The stopwatch measures in 1/10 second increments
- ◆ The stopwatch 1/10 second hand moves for a first minute. After one minute, it indicates the measurement time when it is stopped

REGOLAZIONE DELLA POSIZIONE DELLA LANCETTA DEL CRONOMETRO

Se una delle lancette del cronometro non è in posizione "0", azzerarla seguendo la procedura descritta di seguito:

- ◆ Estrarre la corona dal secondo scatto
- ◆ Premere il pulsante A per riportare le lancette del decimo di secondo alla posizione "0". Premere il pulsante B per riportare le lancette dei secondi alla posizione "0".

*La lancetta dei minuti del cronometro si muove in modo analogo alle lancette dei secondi del cronometro.

*Ogni volta che si preme il pulsante corrispondente, il puntatore si sposta di un passo. Le lancette si muovono rapidamente se i pulsanti sono mantenuti premuti.

- ◆ Spingere la corona nella posizione normale.

