

**Timberland®**





# Movement Specification-1

PE904 12<sub>3/4</sub><sup>'''</sup> Quartz Movement

3Hands with 4 Eyes/Date

(1/10 Second \ Second Chronograph \ Minute & Calendar \ 24 Hours)

## 1. MOVEMENT DIMENSIONS

- Outside diameter  $\varnothing 29.75\text{mm}$
- Total height 4.52mm

## 2. TIME STANDARD

- Frequency of quartz oscillator 32768Hz
- Accuracy Monthly rate: Less than  $\pm 30$  seconds per month at normal temperature range

## 3. BATTERY

- Type Silver oxide battery
- Size  $\varnothing 9.6 \times t 2.1(\text{mm})$
- Recommended battery SR921SW

4. OPERATING TEMPERATURE RANGE From  $-5^{\circ}\text{C} \sim 50^{\circ}\text{C}$

5. OPERATING VOLTAGE 1.25V~1.65V

6. AVERAGE OPERATING CURRENT 2.0 $\mu\text{A}$ ~2.4 $\mu\text{A}$   
(Don't open small seconds time)

7.OUTPUT TORQUE OF SECOND HAND  $\geq 5.5\mu\text{Nm}$

8.The diameter of the dial leg  $\varnothing 0.75(\text{mm})$

9.Surface center bore  $\geq \varnothing 1.80(\text{mm})$

Small needle diameter  $\varnothing 0.195^{+0.006}_{-0.004}$

# Movement Specification-2

PE904

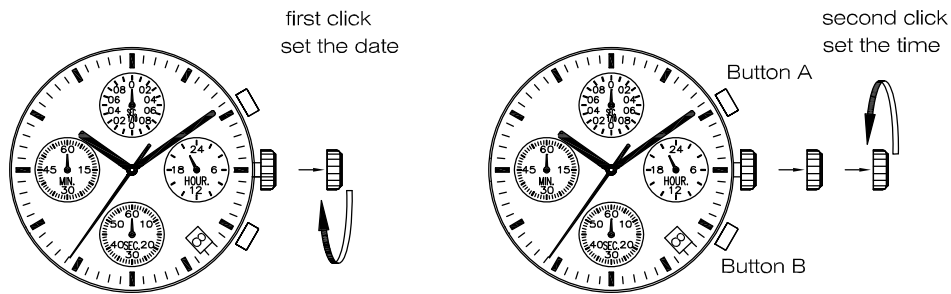
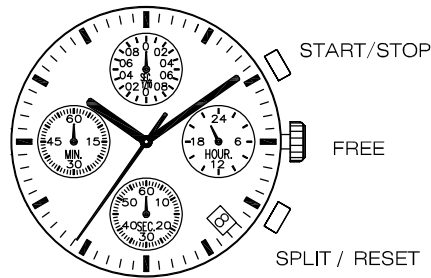
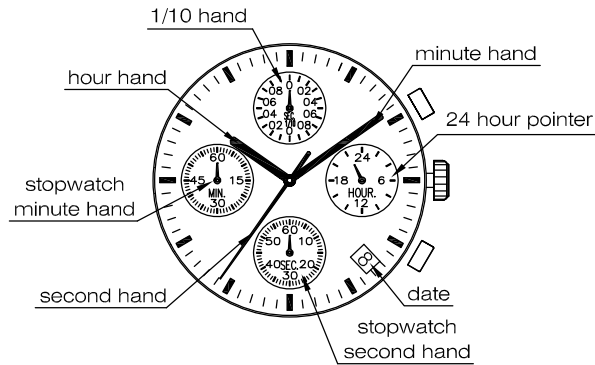

### ADJUSTING THE STOPWATCH HAND POSITION

- 1) Pull the crown out of second click
- 2) Press button A to reset 1/10 second hands to "0" position.  
Press button B to reset Chrono second hands to "0" position.
- 3) Push the crown back to the normal position

Version: 2